



301 N. Hillcrest
Sulphur Springs, TX 75482

2000 I-30 E
Greenville, TX 75402

108 W. Marble
Wylie, TX 75098

Wednesday, November 4, 2020

Office of Hopkins County Judge
PO Box 288
Sulphur Springs TX 75483

Farmers Electric Cooperative Member: Marti Stone
Service Order Number: 2020105685

Greetings:

Farmers Electric Cooperative, Inc. is requesting permission to construct electrical power distribution facilities which will cross County Road 4767 which is located 5000' S of FM 71 W in Hopkins County, Texas.

Site location map and construction sketches are enclosed. The construction sketch details the proposed work. All road crossings will have a minimum vertical clearance of 22 feet.

If you have any questions, please contact me at any time.

Sincerely,

Cody Bland

Project Coordinator
cbland@farmersselectric.coop
Phone 903-456-1722

Submitted by Psalm Harper
pharper@farmersselectric.coop
Field Engineering Coordinator

Enclosures

County Approval Section:

Approved: [Signature] Denied: _____

Authorized Signature: [Signature] Date: 12-7-20

7.2KV



CR 4167

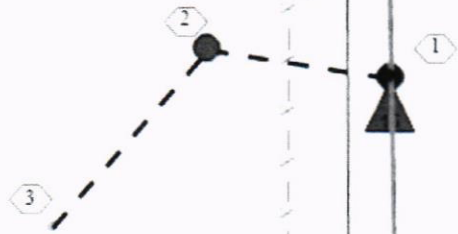

4 ACSR

P1= 5000' FROM
FM 71 W



150ft



ENTRY IS SOUTH
OF THE POLE

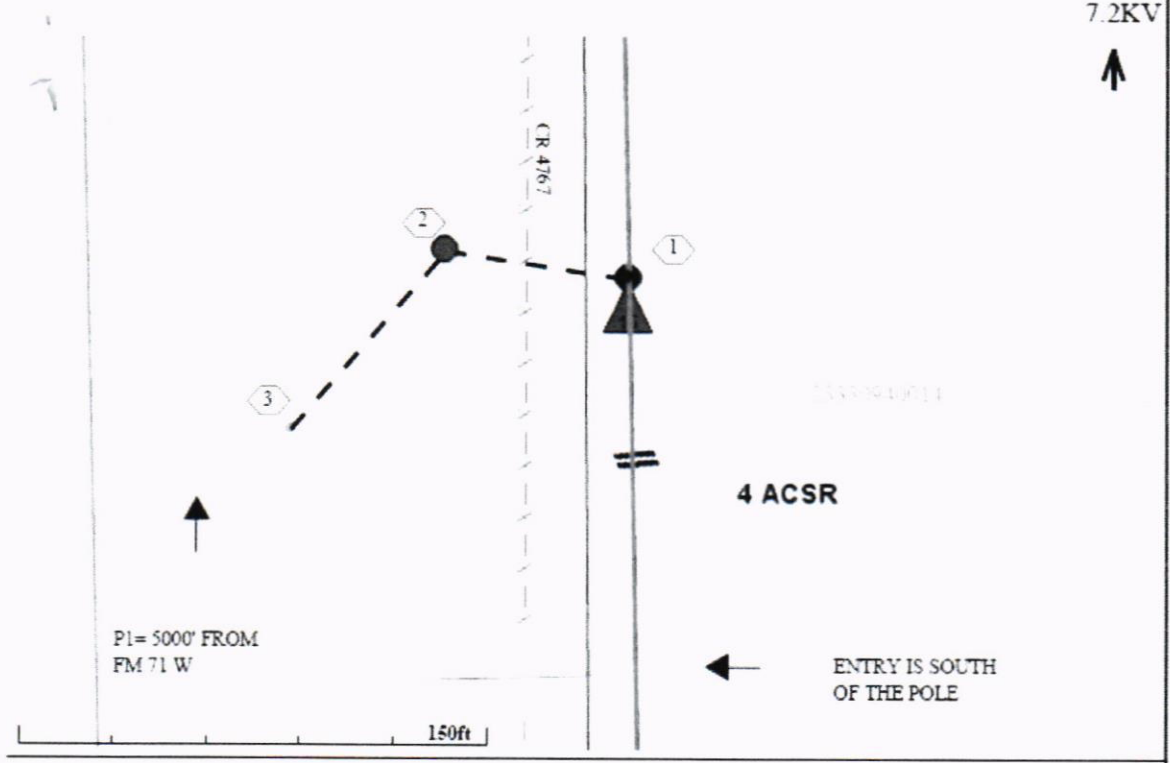

Crossing CR 4767 at Pole 130879 which is 5000' S of FM 71 W

E AREA

ICE AREA
VS ISD

6

DON PHILLIPS

75482

23330940014

1767